



**ROEMHELD**  
HILMA ■ STARK

Issue 7-21 E

# B 1.8268

## Hinge Clamps 70 bar with throttle valve, metallic wiper edge and optional position monitoring double acting, max. operating pressure 70 bar

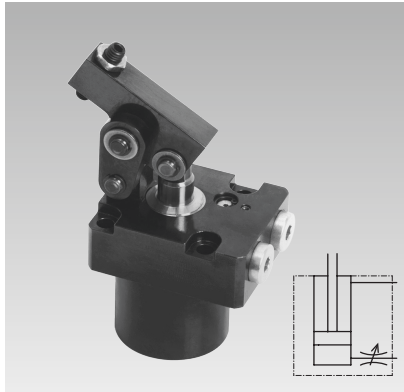

### Advantages

- High clamping force in the low-pressure range
- Very short clamping time (min. 0.5 s)
- Throttle valve as standard, easily adjustable from the top
- Compact design partially recessible
- Lever bolt plain bearing
- 3 clamping directions selectable
- Clamping possible without side loads
- Clamping lever can be swivelled into small recesses
- Long clamping lever adaptable to the work-piece contour
- FKM wiper protected by metallic wiper edge
- Position monitoring available as accessory
- Mounting position: any

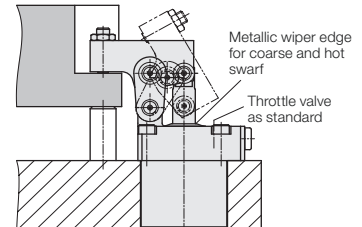

### Application

Hydraulic hinge clamps are used for clamping of workpieces, when it is essential to keep the clamping area free of straps and clamping components for unrestricted workpiece loading and unloading.

A clamping recess in the workpiece a little bit wider than the clamping lever is sufficient as clamping surface.

The special kinematics allow clamping without side loads of workpieces which are very sensitive against deformation.

This series with an operating pressure of 70 bar is designed for the direct connection to the low-pressure hydraulics of machine tools. In combination with the optional pneumatic or electrical position monitorings hinge clamps are particularly suitable for:

- Automatic manufacturing systems with very short cycle times
- Clamping fixtures with workpiece loading by handling systems
- Transfer lines
- Test systems for motors, gears and axes
- Assembly lines
- Special machine tools

### Description

The hinge clamp is a double acting hydraulic cylinder with integrated clamping lever. When pressurising the element, the piston moves upwards and swivels the clamping lever over the hinges forwards and at the same time downwards onto the workpiece. The piston force is deviated by 180° and, depending on the lever length, the force is available as clamping force (see page 4). The kinematics are so designed that no side loads enter into the workpiece, if the clamping surface is at the same height as the centre of rotation of the clamping lever (see comparison "Forces at the clamping point").

The 3 available clamping directions (L, G, R) make it easier to adapt to the workpiece shape or the hydraulic connectivity.

All sizes are optionally available with switch rod for external position monitoring.

Electrical and pneumatic position monitorings for the clamping and unclamping position are available as accessories.

**Important notes** see page 6.

### Forces at the clamping point

**Conventional lever mechanism of other manufacturers**

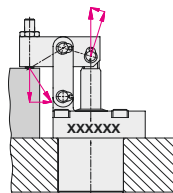

**Lever mechanism without side loads ROEMHELD system**

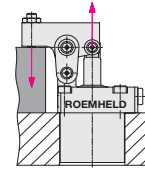

### Installation and connecting possibilities

**Pipe thread**

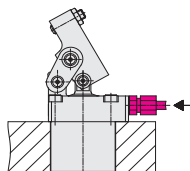

### Drilled channels

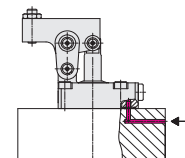

### Versions

**Without switch rod**  
(Option Long clamping lever)

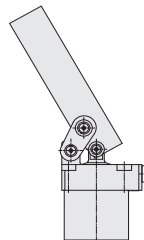

### With switch rod

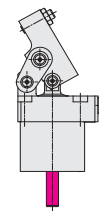

### Clamping direction

Code letters

**L**

**G**

**R**

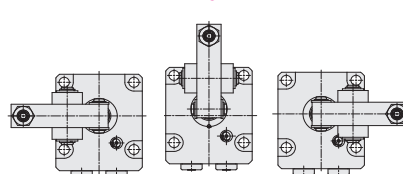

### Accessories – position monitoring

**pneumatic**

**electrical**

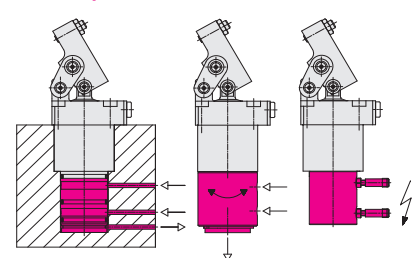

## Versions: without / with switch rod Dimensions • Accessories

### Without switch rod 1826G7X31

Clamping lever with contact bolt

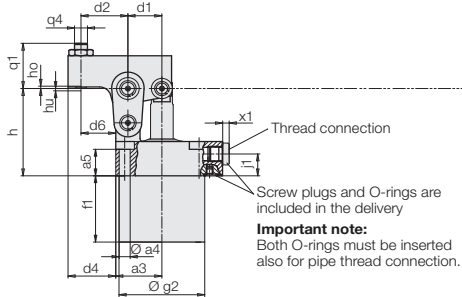

**Important note:**  
Both O-rings must be inserted  
also for pipe thread connection.

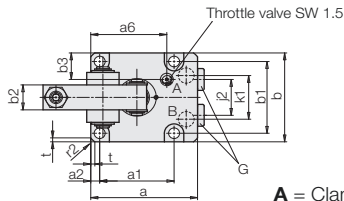

A = Clamping  
B = Unclamping

### Connecting scheme

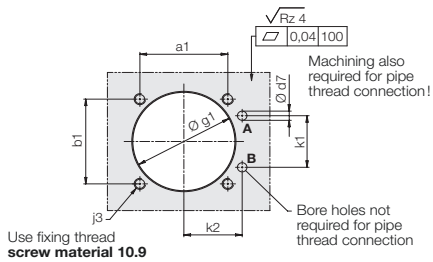

### Clamping direction

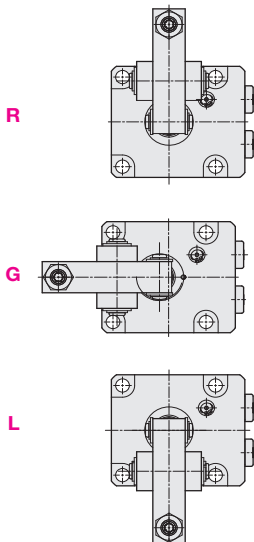

X = code letter for part no.

### With switch rod 1826G7X40

Without clamping lever

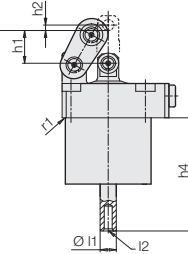

### With switch rod 1826G7X41

Clamping lever with contact bolt

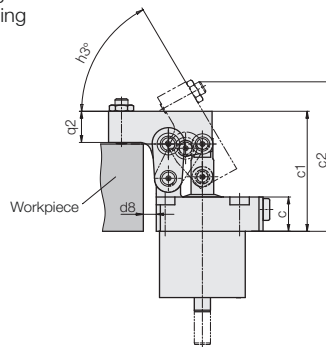

### With switch rod 1826G7X42

Clamping lever, long

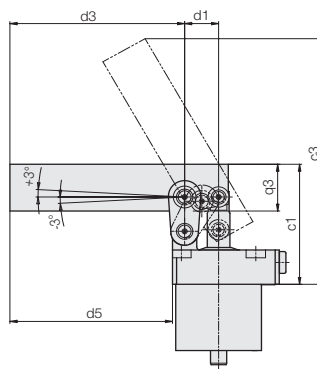

### Connecting dimensions for self-manufactured clamping levers

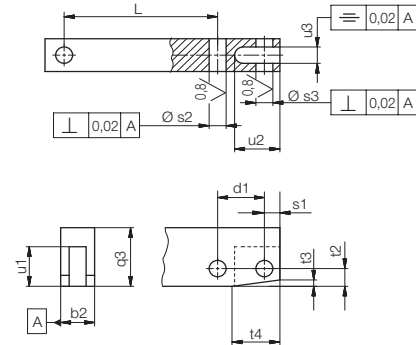

### Accessories

Pneumatic position monitoring (page 5)  
Cartridge type

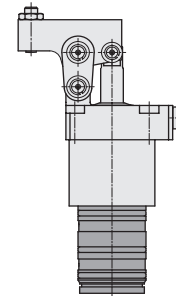

Pipe thread connection

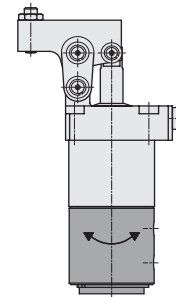

Inductive position monitoring (page 6)

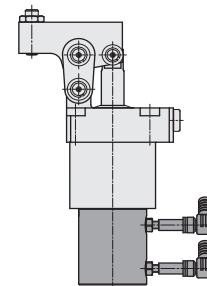

## Technical data

Size			1	2	3	4	5
Max. clamping force	at length of clamping lever d2						
	without switch rod	[kN]	2.6	3.5	4.4	7.3	12.1
	with switch rod	[kN]	2.3	3.1	4	6.8	11.5
Piston force	without switch rod	[kN]	3.4	4.9	6.7	10.6	17.2
	with switch rod	[kN]	3	4.3	6.1	9.8	16.4
Piston Ø		[mm]	25	30	35	44	56
Piston rod Ø		[mm]	12	14	14	16	22
Piston stroke		[mm]	18.7	20.7	24	26	32
Piston area	clamping						
	without switch rod	[cm <sup>2</sup> ]	4.9	7.06	9.62	15.2	24.6
	with switch rod	[cm <sup>2</sup> ]	4.4	6.28	8.83	14	23.4
	unclamping	[cm <sup>2</sup> ]	3.77	5.52	8.08	13.1	20.8
Oil volume	clamping						
	without switch rod	[cm <sup>3</sup> ]	9.2	14.7	23.1	39.6	78.8
	with switch rod	[cm <sup>3</sup> ]	8.3	13	21.2	36.6	75.2
	unclamping	[cm <sup>3</sup> ]	7.1	11.45	19.4	34.3	66.7
Max. flow rate		[cm <sup>3</sup> /s]	16	25	40	75	150
a		[mm]	55	60	66	82	96
a1		[mm]	35	40	46	56	68
a2		[mm]	5	5	5.5	7	9
a3		[mm]	22.5	25	28.5	35	43
Ø a4		[mm]	5.6	5.6	6.8	9	11
a5		[mm]	18	17	17	20	20
a6		[mm]	37.5	41	47	57	70.3
b		[mm]	45	50	57	70	86
b1		[mm]	35	40	46	56	68
b2 – 0.05		[mm]	12	12	16	19	22
b3		[mm]	15.5	14	17	20	24
c		[mm]	22	20.8	22	26	32
c1		[mm]	63.5	68.5	77	93	110
c2		[mm]	79.8	85.5	97	116.5	138.9
c3		[mm]	129.1	152.8	157.6	204	226.8
d1		[mm]	16.5	18.5	21	24.5	30.5
d2		[mm]	20	23.5	29	32	39
d3		[mm]	88	110.5	108	148.5	159.5
d4		[mm]	20	23	29.5	31.5	37.5
d5		[mm]	82	104	100.5	138	147
d6		[mm]	14	17	21.5	21.5	26.5
Ø d7 max.		[mm]	4	4	4	6	6
d8 min.		[mm]	3	4	7	7	8
f1		[mm]	33.5	39.5	42.5	47	55
G			G1/8	G1/8	G1/8	G1/4	G1/4
Ø g1 max.		[mm]	40	48	54	64	79
Ø g2 ±0.1		[mm]	39	47	53	63	78
h	ideal clamping point	[mm]	48.5	51.5	56	67	79
ho	upper end of the clamping range	[mm]	1	1.2	1.5	1.8	2
hu	lower end of the clamping range	[mm]	1.1	1.3	1.5	1.7	2.1
h1	stroke up to the ideal clamping point	[mm]	15.7	17.7	21	23	29
h2	stroke up to the end of the clamping stroke	[mm]	3	3	3	3	3
h3		[°]	57.6	58.6	60.4	57.6	57.4
h4	unclamping position	[mm]	60.2	68.2	72.6	78.1	93.6
j1		[mm]	12.5	12.8	14	14	14
j2		[mm]	20	22	23	30	38
j3	fixing thread		M5	M5	M6	M8	M10
k1		[mm]	22	24	28	36	45
k2		[mm]	25	28	30.5	36	42
Ø l1 f7		[mm]	8	10	10	12	12
l2			M5x15 deep	M6x11.5 deep	M6x11.5 deep	M8x16 deep	M8x16 deep
q1		[mm]	26	26	29	39	48
q2		[mm]	14	16	20	25	30
q3		[mm]	21.5	26	30	36.5	45
q4			M6	M6	M8	M10	M12
r1		[mm]	0.4	0.4	0.4	0.4	0.4
r2		[mm]	7	9	9	11	12
s1		[mm]	5.5	6	6	7	10
Ø s2 H7		[mm]	6	8	8	10	14
Ø s3 H7		[mm]	6	6	7	8	12
t		[mm]	2.4	3.9	2.5	4	4.7
t2		[mm]	6.5	9	9	10.5	14
t3		[mm]	4	3	4.3	5.1	6.6
t4		[mm]	4	17	22	22	31
u1		[mm]	14.5	17.5	17.5	19	28
u2		[mm]	16	16.5	17	19	26
u3 +0.1		[mm]	6.1	6.1	8.1	10.1	11.1
x1		[mm]	4	4	4	5	5
Weight		[kg]	1	1.2	1.5	2.6	4.5
<b>Part no. without switch rod</b>							
without clamping lever			<b>1826X7130</b>	<b>1826X7230</b>	<b>1826X7330</b>	<b>1826X7430</b>	<b>1826X7530</b>
Clamping lever with contact bolt			<b>1826X7131</b>	<b>1826X7231</b>	<b>1826X7331</b>	<b>1826X7431</b>	<b>1826X7531</b>
Clamping lever, long			<b>1826X7132</b>	<b>1826X7232</b>	<b>1826X7332</b>	<b>1826X7432</b>	<b>1826X7532</b>
<b>Part no. with switch rod</b>							
without clamping lever			<b>1826X7140</b>	<b>1826X7240</b>	<b>1826X7340</b>	<b>1826X7440</b>	<b>1826X7540</b>
Clamping lever with contact bolt			<b>1826X7141</b>	<b>1826X7241</b>	<b>1826X7341</b>	<b>1826X7441</b>	<b>1826X7541</b>
Clamping lever, long			<b>1826X7142</b>	<b>1826X7242</b>	<b>1826X7342</b>	<b>1826X7442</b>	<b>1826X7542</b>
<b>Spare O-ring</b>							
Part no.							
			7x1.5	7x1.5	7x1.5	8x1.5	8x1.5
			<b>3000342</b>	<b>3000342</b>	<b>3000342</b>	<b>3000343</b>	<b>3000343</b>

X = Code letter see page 2

## Clamping force diagrams

### Calculation of the clamping force

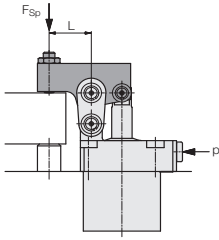

1. Length L of clamping lever is known

1.1 Admissible operating pressure

$$p = \frac{B}{(C/L) + 1} \leq 70 \text{ [bar]}$$

1.2 Effective clamping force

$$(p_{adm} > 70 \text{ bar}) \rightarrow F_{sp} = \frac{A}{L} \cdot 70 \text{ [kN]}$$

$$(p_{adm} > 70 \text{ bar}) \rightarrow F_{sp} = \frac{A}{L} \cdot p_{adm} \text{ [kN]}$$

2. Min. length of clamping lever

$$L_{min} = \frac{C}{(B/p) - 1} \text{ [mm]}$$

L, L<sub>min.</sub> = length of clamping lever [mm]

p, p<sub>adm.</sub> = operating pressure [bar]

A, B, C, = constants as per chart

A\*, B\* for version with switch rod

1826	71	72	73	74	75
<b>A</b>	0.73	1.18	1.82	3.35	6.76
<b>A*</b>	0.65	1.05	1.67	3.11	6.45
<b>B</b>	121.97	119.6	115.62	118.23	119.27
<b>B*</b>	135.89	134.4	125.9	127.73	125
<b>C</b>	14.85	16.65	18.9	22.05	27.45

### Eccentric clamping lever

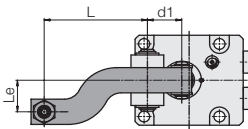

The diagrams show the admissible operating pressure for any combination of length L of clamping lever and the eccentricity Le.

$$\text{Formula } p_{adm} = \frac{X \cdot L}{(Y \cdot Le) + L + Z} \text{ [bar]}$$

L = length of clamping lever,

Le = eccentricity [mm]

X, Y, Z = constant as per chart

X\* for version with switch rod

1826	71	72	73	74	75
<b>X</b>	127.77	125.12	120.69	123.6	124.75
<b>X*</b>	142.34	140.76	131.43	133.49	130.74
<b>Y</b>	3.666	3.7	3.5	3.379	3.588
<b>Z</b>	16.5	18.5	21	24.5	30.5

**Example:** Hinge clamp 1826G72

Special clamping lever L = 60 mm

Eccentricity Le = 45 mm

As per diagram: p<sub>adm</sub> = approx. 30 bar

According to formula:

$$p_{adm} = \frac{X \cdot L}{(y \cdot Le) + L + Z} = \frac{125.12 \cdot 60}{(3.7 \cdot 45) + 60 + 18.5}$$

$$p_{adm} = 30.64 \text{ bar}$$

Effective clamping force ( formula see above)

$$F_{sp} = \frac{A}{L} \cdot p_{adm} = \frac{1.18}{60} \cdot 30.64 = 0.6 \text{ kN}$$

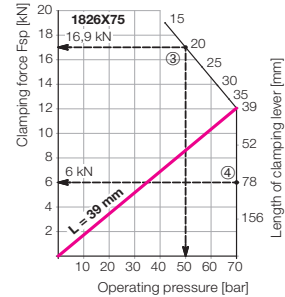
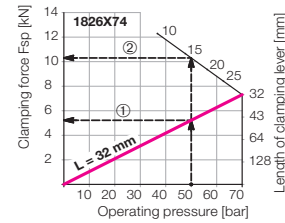
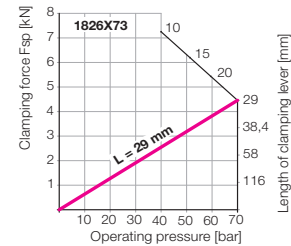
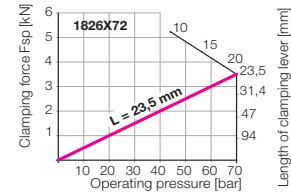
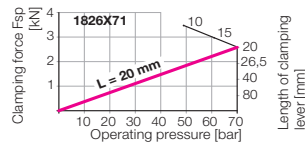

**Example 1:** Hinge clamp 1826G7432  
p = 50 bar; L = 32 mm

Effective clamping force

$$F_{sp} = \frac{A}{L} \cdot p = \frac{3.35}{32} \cdot 50 = 5.2 \text{ kN}$$

**Example 2:** Hinge clamp 1826G7432  
p = 50 bar

Min. length of clamping lever

$$L_{min} = \frac{C}{(B/p) - 1} = \frac{22.05}{(118.23/50) - 1} = 16 \text{ mm}$$

Effective clamping force

$$F_{sp} = \frac{A}{L} \cdot p = \frac{3.35}{16} \cdot 50 = 10.4 \text{ kN}$$

**Example 3:** Hinge clamp 1826G7532

Special clamping lever L = 20 mm

Admissible operating pressure

$$p_{adm} = \frac{B}{(C/L) + 1} = \frac{119.26}{(27.45/20) + 1} = 50.2 \text{ bar}$$

Effective clamping force

$$F_{sp} = \frac{A}{L} \cdot p_{adm} = \frac{6.76}{20} \cdot 50.2 = 16.96 \text{ kN}$$

**Example 4:** Hinge clamp 1826G7532

Special clamping lever L = 78 mm

Admissible operating pressure

$$p_{adm} = \frac{B}{(C/L) + 1} = \frac{119.26}{(27.45/78) + 1} = 88.2 \text{ bar}$$

Effective clamping force

The max. operating pressure is 70 bar, thus

$$F_{sp} = \frac{A}{L} \cdot 70 = \frac{6.76}{78} \cdot 70 = 6 \text{ kN}$$

### Admissible operating pressure p<sub>adm</sub> at eccentric location of the clamping point

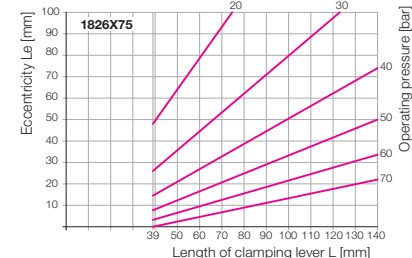
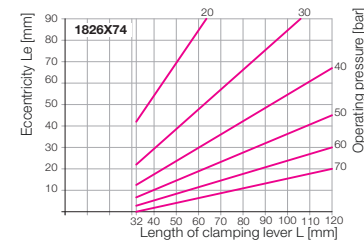
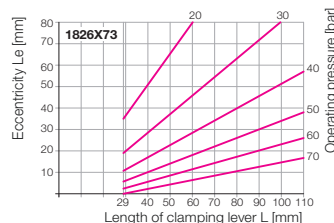
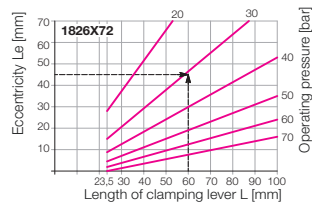
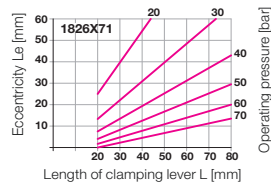

### Important note

Depending on the eccentric load, there will be a one-sided wear of the bolts and an increasing torsion of the clamping lever around the longitudinal axis.

Recommendation: Regular visual inspection

## Accessories Pneumatic position monitoring (not adjustable)

### Application

The pneumatic position monitoring signals the following conditions by closing two bore holes:

1. Piston retracted and clamping lever in off-position
2. Piston in clamping area and clamping lever in clamping position.

For each control function, a pneumatic line has to be provided at the clamping fixture.

### Description

When moving to a switching position, the air pressure in the supply line increases and operates a differential pressure switch or an electro-pneumatic pressure switch.

### Pneumatic port

#### Cartridge type

The hinge clamp with the mounted position monitoring and inserted O-rings is put into the location hole and immediately ready for use.

#### Mounting body

The mounting body is put onto the cartridge-type version and held by the supplied safety ring. The pneumatic ports M5 can be rotated by 360°.

### Monitoring by pneumatic pressure switch

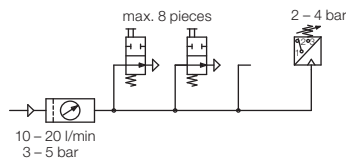

For the evaluation of the pneumatic pressure increase, standard pneumatic pressure switches can be used. With one pressure switch up to 8 position monitorings can be controlled (see circuit diagram).

It has to be considered that process-safe functioning of pneumatic controls is only guaranteed with throttled air pressure and air flow rate.

### Technical data

Connection	Drilled channels or threads M5
Nominal diameter	2 mm
Max. air pressure	10 bar
Range of operating pressure	3...5 bar
Differential pressure*) at 3 bar system pressure	min. 1.5 bar
5 bar system pressure	min. 3.5 bar
Air volume **)	10...20 l/min

\*) Minimum pressure difference, if one or several position monitorings are not operated.

\*\*) For measuring of the flow rate appropriate devices are available.

### Function chart

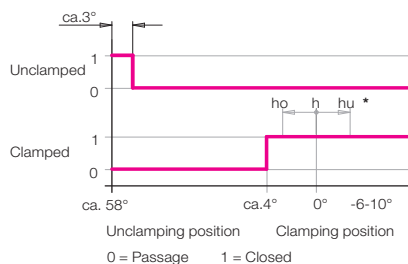

\* Dimensions see page 2 and 3

### Cartridge type

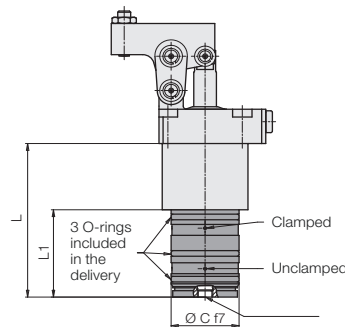

### Pipe thread connection

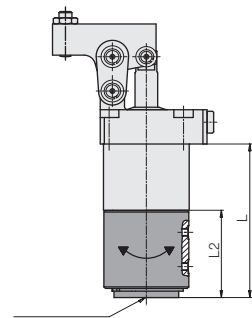

### Location hole

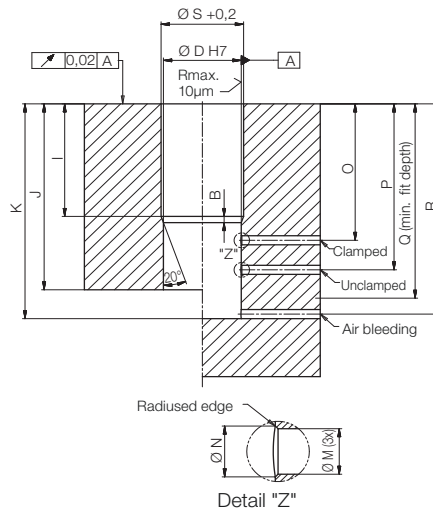

### Mounting body

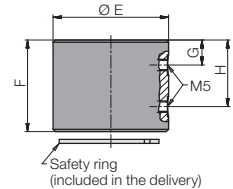

Size	1	2	3	4	5
Ø A ±0.1	[mm] 39	47	53	63	78
B	[mm] 1.3	2	2	2	2
Ø C f7	[mm] 38	42	42	45	45
Ø D H7	[mm] 38	42	42	45	45
Ø E	[mm] 49	53	52.5	62.5	62.5
F	[mm] 40.3	46	50	54	60
G	[mm] 11	13	14	14	15
H	[mm] 29.3	33	36	40	45
I ±0.2	[mm] 34	40	43	47.5	55.5
J min.	[mm] 78	87	91	100	114
K min.	[mm] 84	95	100	109	123
L	[mm] 82.5	93.5	98.5	107	121.5
L1	[mm] 49	54	56	60	66.5
L2	[mm] 46.15	53.85	55.8	59.8	65.8
Ø M	[mm] 4	4	4	4	4
Ø N	[mm] 5	5	5	5	5
O	[mm] 46	52	55.5	60	70.6
P	[mm] 65	74	80	86	100.5
Q min.	[mm] 77	85	90	98.5	113
R	[mm] 79.5	90.5	95.5	104	118.5
Ø S max.	[mm] 40	48	54	64	79

### Part no.

Cartridge type	0353341	0353342	0353343	0353344	0353345
with 4 screws					
Mounting body	0353341A	0353342A	0353343A	0353344A	0353345A
for retrofitting of the cartridge type					

## Accessories

### Electrical position monitoring • Important notes

#### Application

The electrical position monitoring signals the following conditions due to damping of two inductive proximity switches:

1. Piston retracted and clamping lever in off-position
2. Piston extended and clamping lever in off-position.

For each control function, an electrical line has to be provided at the clamping fixture.

#### Description

The electrical position monitoring can be easily retrofitted at all hinge clamps with switch rod (1826X7X4X).

Included in our delivery are:

- 1 Signal sleeve with screw
- 1 Adapter with 4 countersunk screws
- 1 Control housing with 3 set screws
- 2 Inductive proximity switches with right angle plug (if ordered)

The signal sleeve is screwed onto the switch rod. The adapter is mounted with 4 countersunk screws at the bottom cover.

The control housing can be put onto the adapter in any angular position and locked with 3 set screws.

For information on adjustment of proximity switches, see operating manual.

#### Important notes

Inductive position monitorings are not suitable for the use in coolant and swarf areas. According to the corresponding application conditions, safety measures have to be planned and checked later on.

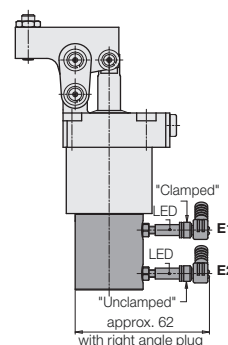
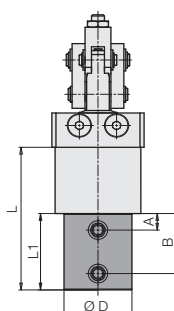

Four fixing screws included in our delivery

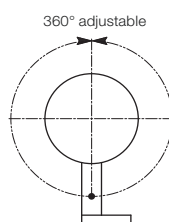

Possible position of the proximity switches

#### Technical data

Operating voltage	10 ... 30 V DC
Max. residual ripple	10 %
Max. constant current	100 mA
Switching function	interlock
Output	PNP
Housing material	stainless steel
Thread	M 5 x 0.5
Code class	IP 67
Ambient temperature	-25 ... +70 °C
LED Function display	yes
Protected against short circuits	yes
Connection type	Plug
Length of cable	5 m

Size	1	2	3	4	5
A	[mm] 12.5	12.5	10.5	10	12
B	[mm] 35	37	38.5	42.5	50
Ø D	[mm] 33	42	42	45	45
L	[mm] 75.5	84.5	91.5	103.5	117
L1	[mm] 42	45	49	56.5	62
<b>Part no.</b>					
without switch	<b>0353351</b>	<b>0353352</b>	<b>0353353</b>	<b>0353354</b>	<b>0353355</b>
with switch and plug	<b>0353351S</b>	<b>0353352S</b>	<b>0353353S</b>	<b>0353354S</b>	<b>0353355S</b>
<b>Spare parts</b>					
Inductive proximity switch	<b>3829198</b>	<b>3829198</b>	<b>3829198</b>	<b>3829198</b>	<b>3829198</b>
Right angle plug with cable 5m	<b>3829099</b>	<b>3829099</b>	<b>3829099</b>	<b>3829099</b>	<b>3829099</b>

#### Function chart

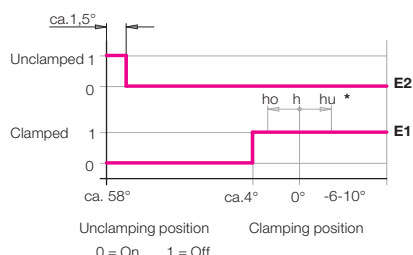

\* Dimensions see page 2 and 3

#### Important notes

Hinge clamps must only be used for clamping of workpieces in industrial applications and may only be operated with hydraulic oil.

Hinge clamps can generate very high forces. The workpiece, the fixture or the machine must be in the position to compensate these forces. Considerable injuries can be caused to fingers during clamping and unclamping in the effective area of the clamping lever.

The manufacturer of the fixture or the machine is obliged to provide effective protection devices. Hinge clamps have to be checked regularly on contamination by swarf and have to be cleaned. Operating conditions, tolerances and other data see data sheet A 0.100.