

## HPT-Series, Ultra-High Pressure Hand Pump

**ENERPAC**

▼ HPT1500



- Lightweight and portable high-pressure hand pump
- Two-speed operation displaces a larger volume of oil per stroke, reducing cycle times for many testing applications
- Includes a pressure gauge and coupler for direct connection to Enerpac Bolt Tensioners
- Integrated relief valve set at 1500 bar.

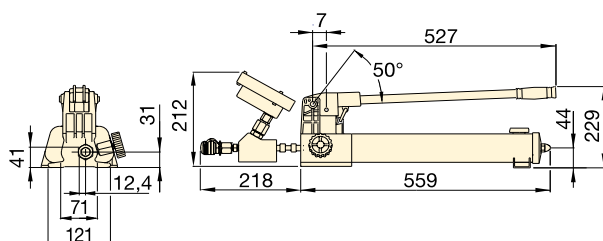

### HPT Series

Reservoir Capacity:

**2,5 litres**

Flow at Rated Pressure:

**0,61 cm<sup>3</sup>/stroke**

Maximum Operating Pressure:

**1500 bar**



#### Applications

The hand pump is ideally suited for use with hydraulic bolt tensioning tools and hydraulic nuts.

Page: 286



#### Ultra-high pressure

This pump operates at ultra-high pressure, use only the specified fittings and hoses designed for these pressures.

Page: 301



#### Bolt Tensioning Theory

See more on tensioning operation and procedures in our "Yellow Pages".

Page: 410



#### Bolting Integrity Software

The software offers Tool selection, Bolt Load calculations and Tool pressure settings, as well as, a combined Application data sheet and Joint completion report. Custom Joint information can also be entered.

Page: 412

### 1500 BAR ULTRA-HIGH PRESSURE PUMP

| Pump Type | Useable Oil Capacity<br>(litres) | Model Number | Pressure Rating<br>(bar) |           | Oil Displacement per Stroke<br>(cm <sup>3</sup> ) |           | High Pressure Oil Port with female coupler | <br>(kg) |
|-----------|----------------------------------|--------------|--------------------------|-----------|---|-----------|--|---|
|           |                                  |              | 1st stage                | 2nd stage | 1st stage   | 2nd stage |  |   |
| Two Speed | 2,54                             | HPT1500      | 14                       | 1500      | 16,22   | 0,61      | 1/4" BSPP + BR-150                         | 9,0   |