

TOGGLE PLIERS

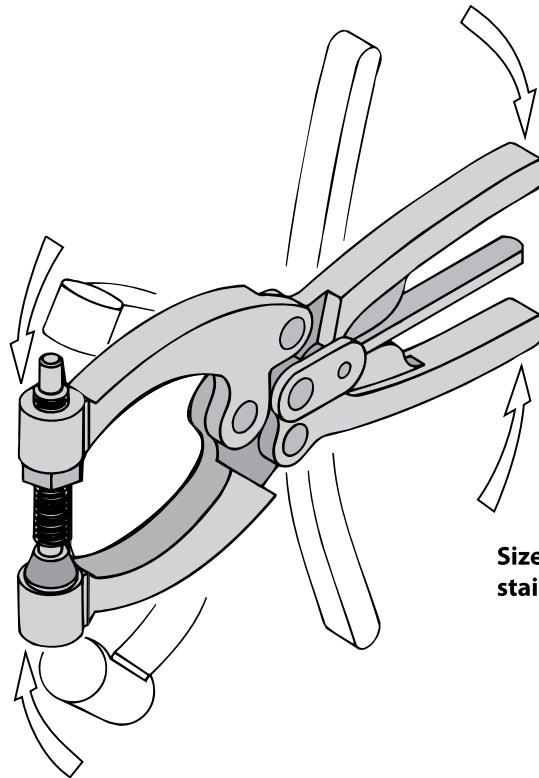

Sizes marked * are also available in stainless steel



200 lbs

350 lbs

700 lbs

700 lbs

700 lbs

Forged Toggle Pliers

Powerful forged steel toggle pliers. Available in five sizes. Larger sizes feature a quick-release lever for easy opening.



800 lbs*

Permanently Attached

Handy weld-on/bolt-on clamp for holding down lids, covers etc. Clamping jaw opens a full 90° for extra clearance.

TOGGLE PLIERS

INFO+: SEE PAGE 415 FOR MATERIAL SPECIFICATIONS



200 lbs

CL-50-PL

Tiny-yet-powerful toggle pliers made of forged steel. 1-inch jaw width. Supplied with 1/4-20 vinyl-coated hex-head spindle CL-14208-SA. Optionally available as CL-50-PL-2 with a bottom-jaw cushion, or as CL-50-PL-3 with (2) vinyl-coated hex-head spindles, CL-14100-SA. Shipping weight 0.4 lbs.

Holding capacity:

200 lbs

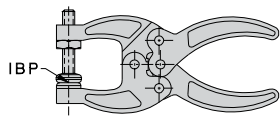

CL-50-PL-2
Hex-Head Spindle
and Bottom Cushion

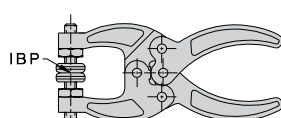

CL-50-PL-3
Dual Hex-Head Spindle

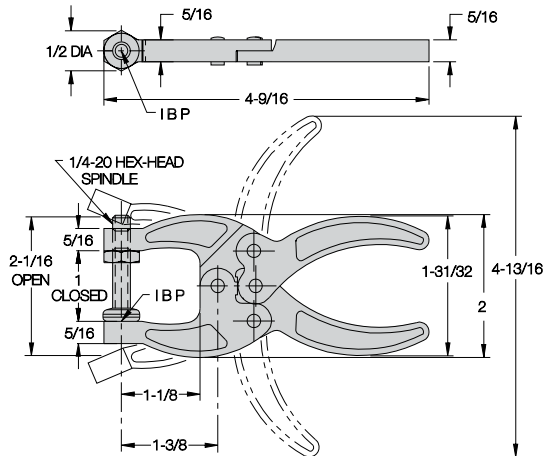

TOGGLE PLIERS

INFO+: SEE PAGE 415 FOR MATERIAL SPECIFICATIONS



350 lbs

CL-150-PL

Medium-size toggle pliers made of forged steel. 1-1/4-inch jaw width. Supplied with 5/16-18 hex-head spindle CL-516212-SA. Shipping weight 0.5 lbs.

Holding capacity:

350 lbs

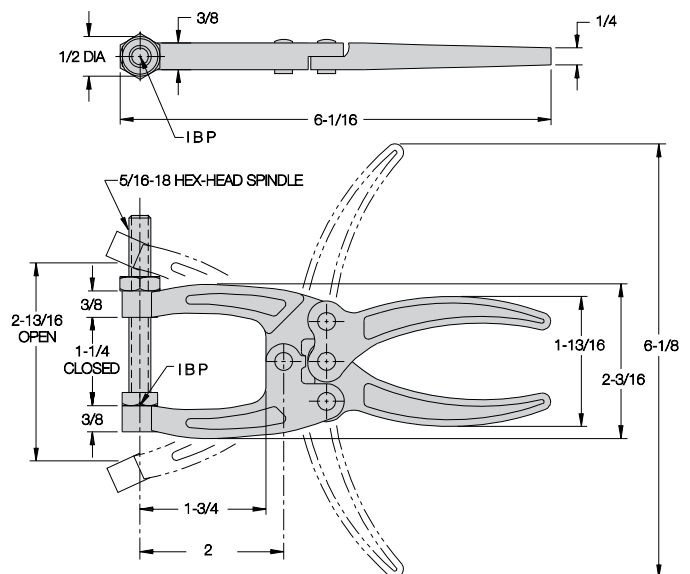

TOGGLE PLIERS

INFO+: SEE PAGE 415 FOR MATERIAL SPECIFICATIONS

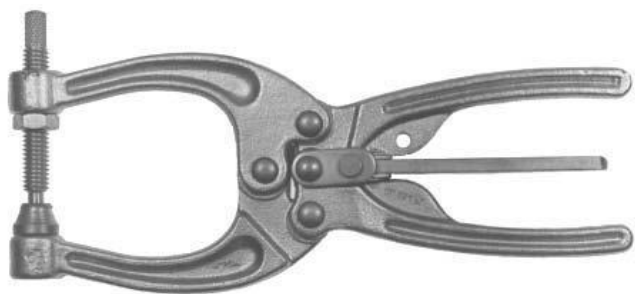

700 lbs

CL-254-PL

Heavy-duty toggle pliers made of forged steel. 1-3/4 inch jaw width. Two-way quick-release lever for easy opening. Supplied with 3/8-16 swivel-foot spindle CL-38314-SF. Optionally available as CL-250-PL with hex-head spindle CL-38314-SA, as CL-254-PL-2 with (2) hex-head spindles CL-38314-SA, or as CL-252-PL with flat-cushion spindle CL-38314-FC. Shipping weight 1.3 lbs.

Holding capacity:

700 Lbs

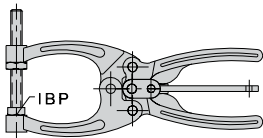
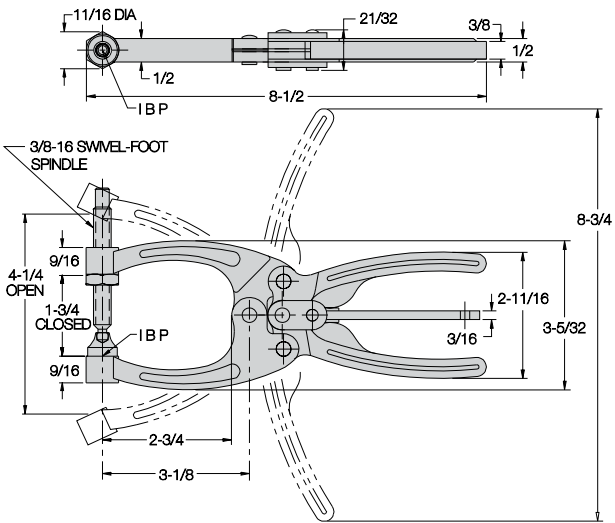

CL-250-PL
Hex-Head Spindle

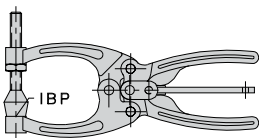

CL-252-PL
Flat Cushion Spindle

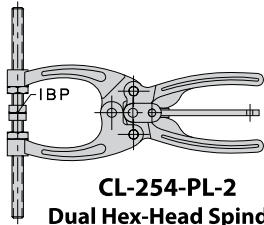

CL-254-PL-2
Dual Hex-Head Spindle

TOGGLE PLIERS

INFO+: SEE PAGE 415 FOR MATERIAL SPECIFICATIONS

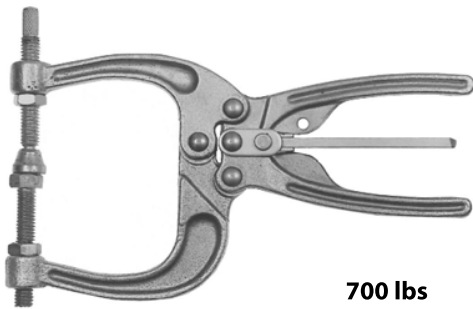

700 lbs

CL-454-PL

Wide-jaw heavy-duty toggle pliers made of forged steel. 3-inch jaw width. Two-way quick-release lever for easy opening. Supplied with 3/8-16 swivel-foot spindle CL-38314-SF and hex-head spindle CL-38314-SA. Shipping weight 1.4 lbs.

Holding capacity:

700 lbs

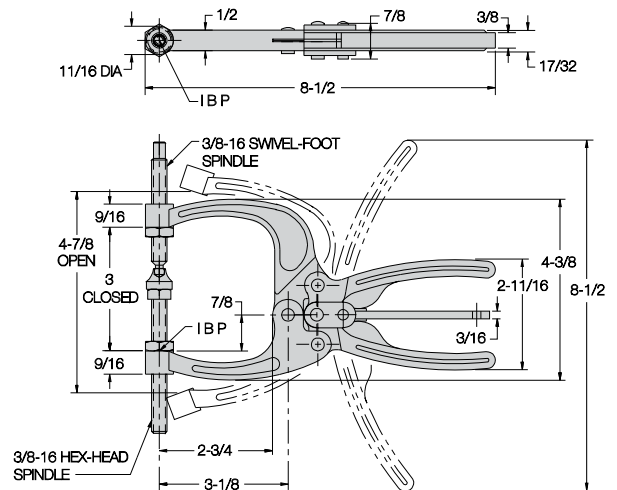

TOGGLE PLIERS

INFO+: SEE PAGE 415 FOR MATERIAL SPECIFICATIONS

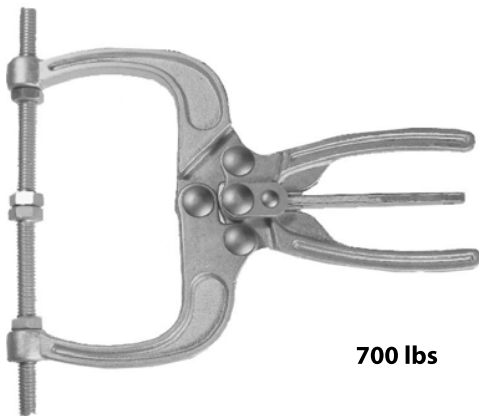

700 lbs

CL-550-PL

Extra-wide-jaw heavy-duty toggle pliers made of forged steel. 4-1/4-inch jaw width. Two-way quick-release lever for easy opening. Supplied with (2) 3/8-16 hex-head spindles CL-38314-SA. Shipping weight 1.6 lbs.

Holding capacity:

700 lbs

