

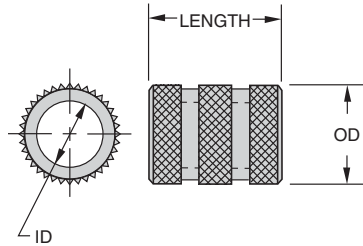

DIAMOND GROOVE DG



APPLICATIONS:

A bushing for cast-in-place or potted installation. Diamond-knurled OD provides superior holding strength against both rotational and axial forces. Since the bushing's OD is not ground, keep the ID accurately located during casting or potting to ensure accuracy in the finished tool.

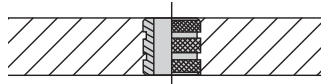

ORDERING EXAMPLES:

- | | |
|-----------------------|--|
| DG-26-16-.1875 | Standard USA bushing, inch ID |
| DG-26-16-.1772 | Standard USA bushing, mm ID (.1772 = 4.50mm) |
| DG-26-16-.1875 REAMER | Reamer tolerance on ID |
| DG-26-16-.1875 NCB | No counterbore on long bushings marked with * (no counterbore is standard on all other bushings) |
| DGM-8-12-4.50 | Standard metric bushing |

Standard prices apply only to bushings with a standard-drill-size ID with the stated ID range. See catalog back cover for standard drill sizes and their decimal equivalents. For prices on non-standard ID sizes, including reamer-tolerance and tap-guide bushings, please contact factory.

STANDARD ID TOLERANCES:

From #55 to 1/4"	+ .0001/+ .0004	From 1 to 3mm	+ .002/+ .008mm
		Over 3 to 6mm	+ .004/+ .012mm
Over 1/4 to 3/4"	+ .0001/+ .0005	Over 6 to 10mm	+ .005/+ .014mm
		Over 10 to 18mm	+ .006/+ .017mm
Over 3/4 to 1-1/2"	+ .0002/+ .0006	Over 18 to 19mm	+ .007/+ .020mm (G6 tolerance)

REAMER ID TOLERANCES:

From #60 to 1/4"	+ .0005/+ .0008	From 1 to 3mm	+ .006/+ .012mm
		Over 3 to 6mm	+ .010/+ .018mm
Over 1/4 to 1"	+ .0006/+ .0010	Over 6 to 10mm	+ .013/+ .022mm
		Over 10 to 18mm	+ .016/+ .027mm
		Over 18 to 19mm	+ .020/+ .033mm (F6 tolerance)

ID RANGE	OD	LENGTH	ANSI PART NO.	PRICE 1-5
.0520-.0995 #55-#39 1.35-2.50mm	13/64 .223-.213	1/4	DG-13-4	Please see our web catalog for pricing.
		5/16	DG-13-5	
		3/8	DG-13-6	
		1/2	DG-13-8	
.0980-.1406 #40-9/64 2.50-3.50mm	1/4 .275-.260	1/4	DG-16-4	
		5/16	DG-16-5	
		3/8	DG-16-6	
		1/2	DG-16-8	
		*3/4	DG-16-12	
.1250-.1935 1/8-#10 3.20-4.90mm	5/16 .337-.322	1/4	DG-20-4	
		5/16	DG-20-5	
		3/8	DG-20-6	
		1/2	DG-20-8	
		3/4	DG-20-12	
.1562-.2570 5/32-F 4.00-6.50mm	13/32 .431-.416	*1	DG-20-16	
		1/4	DG-26-4	
		5/16	DG-26-5	
		3/8	DG-26-6	
		1/2	DG-26-8	
.1562-.3160 5/32-O 4.00-8.00mm	1/2 .525-.510	3/4	DG-26-12	
		*1	DG-26-16	
		5/16	DG-32-5	
		3/8	DG-32-6	
		1/2	DG-32-8	
.3125-.4375 5/16-7/16 7.90-11.00mm	5/8 .650-.635	3/4	DG-32-12	
		*1	DG-32-16	
		3/8	DG-40-6	
		1/2	DG-40-8	
		3/4	DG-40-12	
.3125-.5312 5/16-17/32 8.00-13.00mm	3/4 .775-.760	1	DG-40-16	
		1-3/8	DG-40-22	
		3/8	DG-48-6	
		1/2	DG-48-8	
		3/4	DG-48-12	
.5000-.6562 1/2-21/32 13.00-16.50mm	7/8 .900-.885	1	DG-48-16	
		1-3/8	DG-48-22	
		3/8	DG-56-6	
		1/2	DG-56-8	
		3/4	DG-56-12	
.5000-.7656 1/2-49/64 13.00-19.00mm	1 1.035-1.010	1	DG-56-16	
		1-3/8	DG-56-22	
		1/2	DG-64-8	
		3/4	DG-64-12	
		1	DG-64-16	
		1-3/8	DG-64-22	
		1-1/2	DG-64-24	

* Counterbored, leaving correct drill-bearing length and clearance (see page 514 for bearing length).

QUANTITY DISCOUNTS

Quantity	1	6	12	24	50	100	200	500
	-5	-11	-23	-49	-99	-199	-499	Up
Discount %	Net	18%	29%	34%	42%	48%	50%	52%
Multiplier	1.00	.82	.71	.66	.58	.52	.50	.48

DGM DIAMOND GROOVE METRIC



ID RANGE (G6)	OD	LENGTH	ANSI PART NO.	PRICE 1-5
1.00-1.80mm	5mm 5.50-5.25mm	6mm	DGM-5-6	Please see our web catalog for pricing.
		9mm	DGM-5-9	
1.81-2.60mm		6mm	DGM-5-6	
		9mm	DGM-5-9	
2.61-3.30mm	6mm 6.65-6.25mm	8mm	DGM-6-8	
		12mm	DGM-6-12	
		16mm	DGM-6-16	
3.31-4.00mm	7mm 7.65-7.25mm	8mm	DGM-7-8	
		12mm	DGM-7-12	
		16mm	DGM-7-16	
4.01-5.00mm	8mm 8.65-8.25mm	8mm	DGM-8-8	
		12mm	DGM-8-12	
		16mm	DGM-8-16	
5.01-6.00mm	10mm 10.65-10.25mm	10mm	DGM-10-10	
		16mm	DGM-10-16	
		20mm	DGM-10-20	
6.01-8.00mm	12mm 12.65-12.25mm	10mm	DGM-12-10	
		16mm	DGM-12-16	
		20mm	DGM-12-20	
8.01-10.00mm	15mm 15.65-15.25mm	12mm	DGM-15-12	
		20mm	DGM-15-20	
		25mm	DGM-15-25	
10.01-12.00mm	18mm 18.65-18.25mm	12mm	DGM-18-12	
		20mm	DGM-18-20	
		25mm	DGM-18-25	
12.01-15.00mm	22mm 22.65-22.25mm	16mm	DGM-22-16	
		28mm	DGM-22-28	
		36mm	DGM-22-36	
15.01-18.00mm	26mm 26.90-26.25mm	16mm	DGM-26-16	
		28mm	DGM-26-28	
		36mm	DGM-26-36	

QUANTITY DISCOUNTS

Quantity	1	6	12	24	50	100	200	500
	-5	-11	-23	-49	-99	-199	-499	Up
Discount %	Net	18%	29%	34%	42%	48%	50%	52%
Multiplier	1.00	.82	.71	.66	.58	.52	.50	.48

TRUSTED TO MOVE THE MOST DANGEROUS MATERIALS IN THE WORLD



Carr Lane's Swivel Hoist Rings

Carr Lane offers more hoist rings than any other manufacturer, with more than 20 different types, ranging from economical, low profile versions to heavy-duty, extra-large types with load capacities up to 250,000 lbs.

- Swivel hoist rings
- Safety hoist rings
- Pivoting hoist rings
- Lifting eyes
- Side-pull hoist rings





Visit our online catalog at CarrLane.com

CarrLane
MANUFACTURING CO.
4200 Carr Lane Ct., P.O. Box 19-070 • St. Louis, Missouri 63119-7970 USA
Phone: 314/647-6200 • Fax: 314/647-5736 • Web Site: www.carrlane.com