

## Air Filter/Regulator Assembly

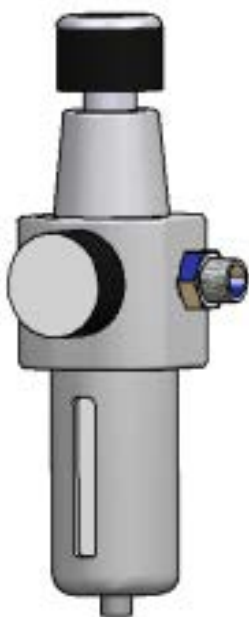

A range of compressed air filter regulators with automatic drain, pressure gauge and fitting to enable direct mounting on GX and KR series pumps. Additional wall mounting brackets, shut-off valves and emergency dump valves are available from HYQUIP.

Note: To achieve maximum flow and pressure with GX series pumps use 6B\* or 6N\* variant of filter/regulator.

Pump Range	Thread	Ordering Code
GX**-B**	G ½"	HA-FR-GX-4B
GX**-B**	G ¾"	HA-FR-GX-6B
GX**-S**	½" NPT	HA-FR-GX-4N (US use only)
GX**-S**	¾" NPT	HA-FR-GX-6N (US use only)
KR**-B**	G ⅜"	HA-FR-KR-3B
KR**-S**	¼" NPT	HA-FR-KR-2N (US use only)