

HXD-Series, Hexagon Cassette Wrenches

ENERPAC
POWERFUL SOLUTIONS. GLOBAL FORCE.

▼ HXD-60 with CC-680



- High torque-to-weight ratio, slim nose radius and flat design
- High speed, high degree of rotation angle
- Snap in, interchangeable cassettes, no tools required
- 360° swivel hose connection allows easier positioning in confined areas
- High repeatability, with accuracy $\pm 3\%$
- Strong unibody design, integrated reaction arm and few moving parts make wrenches durable and reliable
- Extensive range of metric and imperial hexagon cassettes and reducers
- Drive unit and cassette come in storage case to protect from damage, water and dirt
- Lock-ring couplers are standard.

▼ The HXD-30 drive unit combined with cassette CC-3238 is the best solution for this turbine application. The slim nose radius and swivel couplers allow easy access in all positions.



Aluminium, Low Profile



Twin 3,5:1 Safety Hoses

Use only Enerpac THC-700 series twin 3,5:1 safety hoses with HXD double-acting wrenches to ensure the integrity of your system.

Page: 32



Nut Cutters

Remove rusted or corroded nuts easily with Enerpac Nut Cutters. Cuts hexagon nut sizes up to 130 mm.

Page: 61



Select the Right Torque

Choose your Enerpac Torque Wrench using the loosening torque rule of thumb:

Loosening torque may require 250% of tightening torque depending on the condition of the fastener.

Page: 73

▼ An Enerpac HXD hydraulic wrench brings safety and efficiency to this flange maintenance job at a refinery.



Double-Acting Hydraulic Torque Wrenches

▼ Shown from left to right: CC-3238, HXD-30



Torque Wrench Selection in 2 steps:

- 1. Drive Unit**
Select the HXD-drive Unit using the quick selection chart below.
- 2. Cassette**
Select the appropriate CC-cassette from pages 30 and 31.

HXD Series



Maximum Torque:
24.210 Nm

Hexagon Range:
32-130 mm / 1¼-5 inch

Nose Radius:
28,5 - 96,0 mm

Maximum Operating Pressure:
800 bar



Metric and Imperial Sizes

Expanded versatility with the full range of metric and imperial Reducer Inserts and Holding Rings.

Page: 30



Hexagon Bolt and Nut Sizes

See the table for hexagon sizes of bolts, nuts and related thread diameters.

Page: 76



Torque Wrench Pumps

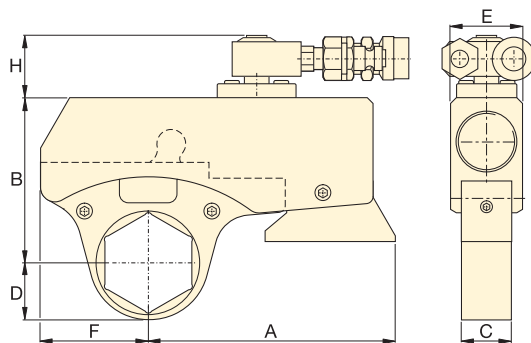
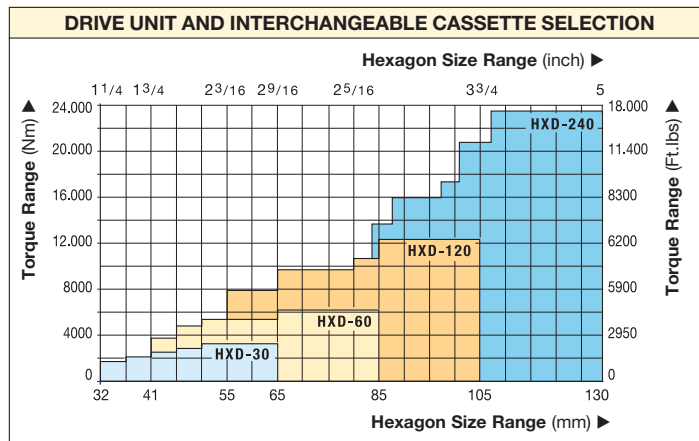

System matched air and electric pumps provide control to operate Enerpac HXD Torque Wrenches.

Page: 32



Drive Unit with Cassette

▼ QUICK SELECTION CHART

Cassette Range  Page: 30	Maximum Torque at 800 bar (Nm)	Drive Unit * Model Number 	Drive Unit and Cassette Dimensions (mm)								Weight (including smallest cassette) (kg)
			A	B	C	D	E	F	H		
32 - 60 (mm) 1¼ - 2¾ (inch)	3290	HXD-30	135	91 - 103	28	28,5 - 47,5	40	60	38	1,6	
41 - 80	6190	HXD-60	156	115 - 130	35	34,5 - 60,5	50	75	38	2,5	
55 - 100	12.500	HXD-120	200	141 - 156	47	46,5 - 73,5	65	96	38	4,8	
80 - 130	24.210	HXD-240	259	182 - 202	56	62,0 - 96,0	82	125	50	8,2	

* With integrated reaction arm.

HXD-Series, Inch-Cassettes and Inserts

ENERPAC
POWERFUL SOLUTIONS. GLOBAL FORCE.



Maximum Torque at 800 bar:

24.210 Nm

Hexagon Range:

1 1/4 - 5 inch





◀ The optional Reducer Insert must be secured in the Cassette with a Holding Ring.

**CC
IN
HR
Series**



▼ SELECTION CHART

DRIVE UNIT 	INTERCHANGEABLE CASSETTE, IMPERIAL					OPTIONAL ADD-ON REDUCER INSERTS, IMPERIAL				HOLDING RINGS 
	Max. Torque (Nm)	Hex. Size ¹⁾ (inch)	Nose Radius D (mm)	Model Number	Weight (kg)	Hexagon Size (inch)	Model Number	Hexagon Size (inch)	Model Number	
HXD-30 (3290 Nm)	1700	1 1/4	28,5	CC-3125	0,6	-	-	-	-	-
	2100	1 7/16	31,5	CC-3144	0,7	1 7/16 - 1 1/4	IN3144-125	-	-	HR-36
	2500	1 5/8	34,5	CC-3163	0,7	1 5/8 - 1 7/16	IN3163-144	1 5/8 - 1 1/4	IN3163-125	HR-41
	2890	1 13/16	38,5	CC-3181	0,8	1 13/16 - 1 5/8	IN3181-163	1 13/16 - 1 7/16	IN3181-144	HR-46
	3290	2	42,0	CC-3200	0,9	2 - 1 13/16	IN3200-181	2 - 1 5/8	IN3200-163	HR-50
		2 3/16	45,0	CC-3219	1,0	2 3/16 - 2	IN3219-200	2 3/16 - 1 13/16	IN3219-181	HR-55
	2 3/8	47,5	CC-3238	1,1	2 3/8 - 2 3/16	IN3238-219	2 3/8 - 2	IN3238-200	HR-60	
HXD-60 (6190 Nm)	3840	1 5/8	34,5	CC-6163	1,2	-	-	-	-	-
	4805	1 13/16	39,5	CC-6181	1,3	1 13/16 - 1 5/8	IN6181-163	-	-	HR-46
	5410	2	43,5	CC-6200	1,4	2 - 1 13/16	IN6200-181	2 - 1 5/8	IN6200-163	HR-50
		2 3/16	46,5	CC-6219	1,5	2 3/16 - 2	IN6219-200	2 3/16 - 1 13/16	IN6219-181	HR-55
		2 3/8	48,5	CC-6238	1,6	2 3/8 - 2 3/16	IN6238-219	2 3/8 - 2	IN6238-200	HR-60
	6190	2 3/4	52,5	CC-6256	1,8	2 3/4 - 2 3/8	IN6256-238	2 3/4 - 2 3/16	IN6256-219	HR-65
		2 5/8	55,5	CC-6275	1,9	2 5/8 - 2 3/4	IN6275-256	2 5/8 - 2 3/8	IN6275-238	HR-70
		2 15/16	57,5	CC-6293	2,0	2 15/16 - 2 3/4	IN6293-275	2 15/16 - 2 3/8	IN6293-256	HR-75
		3 1/8	60,5	CC-6313	2,1	3 1/8 - 2 15/16	IN6313-293	3 1/8 - 2 3/4	IN6313-275	HR-80
	HXD-120 (12.500 Nm)	8000	2 3/16	46,5	CC-12219	2,6	2 3/16 - 2	IN12219-200	2 3/16 - 1 13/16	IN12219-181
2 3/8			48,5	CC-12238	2,7	2 3/8 - 2 3/16	IN12238-219	2 3/8 - 2	IN12238-200	HR-60
9800		2 3/16	52,5	CC-12256	2,7	2 3/16 - 2 3/8	IN12256-238	2 3/16 - 2 3/16	IN12256-219	HR-65
		2 3/4	55,5	CC-12275	2,8	2 3/4 - 2 3/16	IN12275-256	2 3/4 - 2 3/8	IN12275-238	HR-70
		2 15/16	57,5	CC-12293	2,9	2 15/16 - 2 3/4	IN12293-275	2 15/16 - 2 3/8	IN12293-256	HR-75
10.860		3	57,5	CC-12300	2,9	3 - 2 3/4	IN12300-275	3 - 2 3/8	IN12300-256	HR-75
		3 1/8	60,5	CC-12313	3,0	3 1/8 - 2 15/16	IN12313-293	3 1/8 - 2 3/4	IN12313-275	HR-80
12.500		3 3/8	64,5	CC-12338	3,5	3 3/8 - 3	IN12338-300	3 3/8 - 2 15/16	IN12338-293	HR-85
		3 1/2	67,5	CC-12350	3,6	3 1/2 - 3 1/8	IN12350-313	3 1/2 - 3	IN12350-300	HR-90
		3 3/4	70,5	CC-12375	3,7	3 3/4 - 3 1/2	IN12375-350	3 3/4 - 3 3/8	IN12375-338	HR-95
		3 7/8	73,5	CC-12388	3,8	3 7/8 - 3 1/2	IN12388-350	3 7/8 - 3 3/8	IN12388-338	HR-100
HXD-240 (24.210 Nm)		14.000	3 1/8	62,0	CC-24313 ²⁾	5,1	3 1/8 - 2 15/16	IN24313-293	3 1/8 - 2 3/4	IN24313-275
	15.840	3 3/8	66,0	CC-24338	5,2	3 3/8 - 3 1/8	IN24338-313	3 3/8 - 3	IN24338-300	HR-85
	16.570	3 1/2	69,0	CC-24350	5,2	3 1/2 - 3 3/8	IN24350-313	3 1/2 - 3	IN24350-300	HR-90
	17.320	3 3/4	72,0	CC-24375	5,4	3 3/4 - 3 1/2	IN24375-350	3 3/4 - 3 3/8	IN24375-338	HR-95
	18.050	3 7/8	76,0	CC-24388 ³⁾	5,6	4 1/8 - 3 7/8	IN24413-388	3 7/8 - 3 3/8	IN24388-338	HR-100
	21.000	4 1/8	80,0	CC-24413	5,7	4 1/4 - 3 7/8	IN24425-388	4 1/8 - 3 3/4	IN24413-375	HR-105
	24.210	4 1/4	84,0	CC-24425	6,8	4 5/8 - 4 1/4	IN24463-425	4 1/4 - 3 3/4	IN24425-375	HR-110
		4 3/8	90,0	CC-24463	7,3	5 - 4 5/8	IN24500-463	4 5/8 - 4 1/8	IN24463-413	HR-120
		5	96,0	CC-24500	7,4	-	-	5 - 4 1/4	IN24500-425	HR-130

Other Reducer Insert dimensions available upon request.
¹⁾ See the table of hexagon bolt and nut sizes and related thread diameters on page 76.
²⁾ Additional Reducer Insert: 3 1/8"-2 15/16" IN24313-256 fits CC-24313 Cassette. Use HR-80 Holding Ring.
³⁾ Additional Reducer Insert: 3 3/4"-2 3/16" IN24375-313 fits CC-24388 Cassette. Use HR-100 Holding Ring.

HXD-Series, Metric Cassettes and Reducer Inserts



Maximum Torque at 800 bar:

24.210 Nm

Hexagon Range:

32 - 130 mm



◀ The optional Reducer Insert must be secured in the Cassette with a Holding Ring.

**CC
IN
HR
Series**



▼ SELECTION CHART

DRIVE UNIT	INTERCHANGEABLE CASSETTES, METRIC					OPTIONAL ADD-ON REDUCER INSERTS, METRIC						HOLDING RINGS
	Model Number (max. capacity)	Max. Torque (Nm)	Hex. Size ¹⁾ (mm)	Nose Radius D (mm)	Model Number ▲ (kg)	Hexagon Size (mm)	Model Number	Hexagon Size (mm)	Model Number	Hexagon Size (mm)	Model Number	
HXD-30 (3290 Nm)	1700	32	28,5	CC-332	0,6	-	-	-	-	-	-	-
	2100	36	31,5	CC-336	0,7	-	-	-	-	-	-	-
	2500	41	34,5	CC-341	0,7	41/36	IN3-4136	41/32	IN3-4132	41/30	IN3-4130	HR-41
	2890	46	38,5	CC-346	0,8	46/41	IN3-4641	46/36	IN3-4636	46/32	IN3-4632	HR-46
	3290	50	42,0	CC-350	0,9	50/46	IN3-5046	50/41	IN3-5041	50/36	IN3-5036	HR-50
		55	45,0	CC-355	1,0	55/50	IN3-5550	55/46	IN3-5546	55/41	IN3-5541	HR-55
	60	47,5	CC-360	1,1	60/55	IN3-6055	60/50	IN3-6050	60/46	IN3-6046	HR-60	
HXD-60 (6190 Nm)	3840	41	34,5	CC-641	1,2	41/36	IN6-4136	-	-	-	-	HR-41
	4805	46	39,5	CC-646	1,3	-	-	-	-	-	-	-
	5410	50	43,5	CC-650	1,4	50/46	IN6-5046	50/41	IN6-5041	50/36	IN6-5036	HR-50
		55	46,5	CC-655	1,5	55/50	IN6-5550	55/46	IN6-5546	55/41	IN6-5541	HR-55
		60	48,5	CC-660	1,6	60/55	IN6-6055	60/50	IN6-6050	60/46	IN6-6046	HR-60
	6190	65	52,5	CC-665	1,8	65/60	IN6-6560	65/55	IN6-6555	65/50	IN6-6550	HR-65
		70	55,5	CC-670	1,9	70/65	IN6-7065	70/60	IN6-7060	70/55	IN6-7055	HR-70
		75	57,5	CC-675	2,0	75/70	IN6-7570	75/65	IN6-7565	75/60	IN6-7560	HR-75
		80	60,5	CC-680	2,1	80/75	IN6-8075	80/70	IN6-8070	80/65	IN6-8065	HR-80
	HXD-120 (12.500 Nm)	8000	55	46,5	CC-1255	2,6	55/50	IN12-5550	55/46	IN12-5546	55/41	IN12-5541
60			48,5	CC-1260	2,7	60/55	IN12-6055	60/50	IN12-6050	60/46	IN12-6046	HR-60
65			52,5	CC-1265	2,7	65/60	IN12-6560	65/55	IN12-6555	65/50	IN12-6550	HR-65
9800		70	55,5	CC-1270	2,8	70/65	IN12-7065	70/60	IN12-7060	70/55	IN12-7055	HR-70
		75	57,5	CC-1275	2,9	75/70	IN12-7570	75/65	IN12-7565	75/60	IN12-7560	HR-75
		-	-	-	-	-	-	-	-	-	-	-
10.860		80	60,5	CC-1280	3,0	80/75	IN12-8075	80/70	IN12-8070	80/65	IN12-8065	HR-80
12.500		85	64,5	CC-1285	3,5	85/80	IN12-8580	85/75	IN12-8575	85/70	IN12-8570	HR-85
		90	67,5	CC-1290	3,6	90/85	IN12-9085	90/80	IN12-9080	90/75	IN12-9075	HR-90
		95	70,5	CC-1295	3,7	95/90	IN12-9590	95/85	IN12-9585	95/80	IN12-9580	HR-95
	100	73,5	CC-12100	3,8	100/95	IN12-10095	100/90	IN12-10090	100/85	IN12-10085	HR-100	
HXD-240 (24.210 Nm)	13.890	80	62,0	CC-2480	5,1	80/75	IN24-8075	80/70	IN24-8070	80/65	IN24-8065	HR-80
	16.030	85	66,0	CC-2485	5,2	85/80	IN24-8580	85/75	IN24-8575	85/70	IN24-8570	HR-85
	16.560	90	69,0	CC-2490	5,2	90/85	IN24-9085	90/80	IN24-9080	90/75	IN24-9075	HR-90
	17.100	95	72,0	CC-2495	5,4	95/90	IN24-9590	95/85	IN24-9585	95/80	IN24-9580	HR-95
	18.170	100	76,0	CC-24100	5,6	100/95	IN24-10095	100/90	IN24-10090	100/85	IN24-10085	HR-100
	20.840	105	80,0	CC-24105	5,7	105/100	IN24-105100	105/95	IN24-10595	105/90	IN24-10590	HR-105
	24.210	110	84,0	CC-24110	5,8	110/105	IN24-110105	110/100	IN24-110100	110/95	IN24-11095	HR-110
		115	87,0	CC-24115	7,1	115/110	IN24-115110	115/105	IN24-115105	115/100	IN24-115100	HR-115
		120	90,0	CC-24120	7,3	120/115	IN24-120115	120/110	IN24-120110	120/105	IN24-120105	HR-120
		125	93,0	CC-24125	7,3	125/120	IN24-125120	125/115	IN24-125115	125/110	IN24-125110	HR-125
		130	96,0	CC-24130	7,4	130/125	IN24-130125	130/120	IN24-130120	130/115	IN24-130115	HR-130

Other Reducer Insert dimensions available upon request.

¹⁾ See the table of hexagon bolt and nut sizes and related thread diameters on page 76.