

## BALL LOCK RECEIVER CAPS

300-SERIES STAINLESS STEEL, PASSIVATED

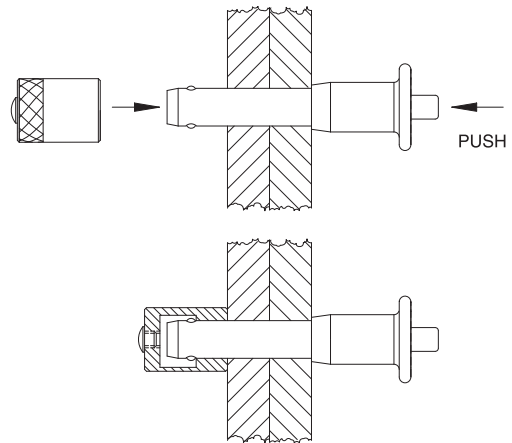

**IMPROVED DESIGN –  
NOW AVAILABLE FOR ALL  
STANDARD BALL LOCK  
PIN DIAMETERS!**



Receiver Caps are ideal for securing Ball Lock Pins used in clevis applications, especially when the through-hole has excess clearance. The Receiver Cap's inside diameter fits the Ball Lock Pin exactly, and is stepped to provide a perfect locking surface for the balls. Available to fit Ball Lock Pin diameters from 3/16 to 1" (5 to 20mm in metric). Made of 300-series stainless steel. Please note, using a Receiver Cap reduces the Ball Lock Pin's effective grip length slightly (see D dimension).

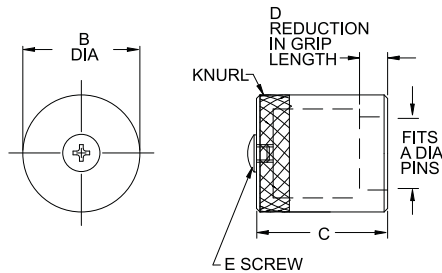

Receiver Caps are tapped to allow fastening the eyelet end of a standard Ball Lock Pin Cable Assembly (12' long) or Nylon Lanyard (10' long), and include a fastening screw.

### USA

PART NO.	A DIA	B DIA	C	D	E
CL-3-BLR-S	3/16 (#10)	.50	.72	1/4	#10-32
CL-4-BLR-S	1/4	.50	.81		
CL-5-BLR-S	5/16	.63	.81		
CL-6-BLR-S	3/8	.75	1.16		
CL-7-BLR-S	7/16	.75	1.16	1/2	
CL-8-BLR-S	1/2	.88	1.25		
CL-9-BLR-S	9/16	.88	1.25		
CL-10-BLR-S	5/8	1.00	1.31		
CL-12-BLR-S	3/5	1.25	1.45		
CL-14-BLR-S	7/8	1.50	1.48		
CL-16-BLR-S	1	1.50	1.69		

### METRIC

PART NO.	A DIA	B DIA	C	D	E
CLM-5-BLR-S	5mm	.50	.93	.39 (10mm)	M5
CLM-6-BLR-S	6mm	.50	.95		
CLM-8-BLR-S	8mm	.63	1.00		
CLM-10-BLR-S	10mm	.75	1.03		
CLM-12-BLR-S	12mm	.88	1.13		
CLM-16-BLR-S	16mm	1.00	1.25		
CLM-20-BLR-S	20mm	1.25	1.50		