

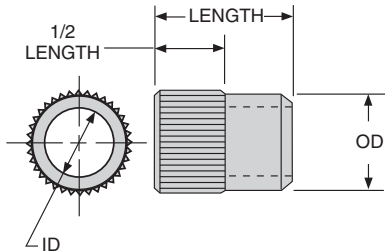

SERRATED PRESS FIT SP



APPLICATIONS:

Similar to a P bushing, but with top serrations to prevent rotation in soft materials. Recommended in high-torque situations for materials such as magnesium, aluminum, masonite, or wood. Finish-ground OD ensures accurate ID location. Serrations also resist axial force to prevent pushing the bushing through the jig plate.

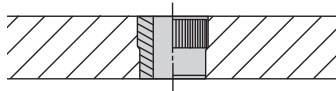

ORDERING EXAMPLES:

- SP-26-16-.1875 Standard USA bushing, inch ID
- SP-26-16-.1772 Standard USA bushing, mm ID (.1772 - 4.50mm)
- SP-26-16-.1875 REAMER Reamer tolerance on ID
- SP-26-16-.1875 NCB No counterbore on long bushings marked with * (no counterbore is standard on all other bushings)
- SPM-8-12-4.50 Standard metric bushing

Standard prices apply only to bushings with a standard-drill-size ID with the stated ID range. See catalog back cover for standard drill sizes and their decimal equivalents. For prices on non-standard ID sizes, including reamer-tolerance and tap-guide bushings, please contact factory.

STANDARD ID TOLERANCES:

From #55 to 1/4"	+0.001/+0.004	From 1 to 3mm	+0.02/+0.08mm
		Over 3 to 6mm	+0.04/+0.12mm
Over 1/4 to 3/4"	+0.001/+0.005	Over 6 to 10mm	+0.05/+0.14mm
		Over 10 to 18mm	+0.06/+0.17mm
Over 3/4 to 1-1/2"	+0.002/+0.006	Over 18 to 19mm	+0.07/+0.20mm (G6 tolerance)

REAMER ID TOLERANCES:

From #60 to 1/4"	+0.005/+0.008	From 1 to 3mm	+0.06/+0.12mm
		Over 3 to 6mm	+0.10/+0.18mm
Over 1/4 to 1"	+0.006/+0.010	Over 6 to 10mm	+0.13/+0.22mm
		Over 10 to 18mm	+0.16/+0.27mm
		Over 18 to 19mm	+0.20/+0.33mm (F6 tolerance)

ID RANGE	OD	LENGTH	ANSI PART NO.	PRICE 1-5
.0520-.0995 #55-#39 1.35-2.50mm	13/64 .2031-.2029	1/4	SP-13-4	
		5/16	SP-13-5	
		3/8	SP-13-6	
		1/2	SP-13-8	
.0980-.1406 #40-9/64 2.50-3.50mm	1/4 .2500-.2498	1/4	SP-16-4	
		5/16	SP-16-5	
		3/8	SP-16-6	
		1/2	SP-16-8	
.1250-.1935 1/8-#10 3.20-4.90mm	5/16 .3125-.3123	1/4	SP-20-4	
		5/16	SP-20-5	
		3/8	SP-20-6	
		1/2	SP-20-8	
		3/4	SP-20-12	
.1562-.2570 5/32-F 4.00-6.50mm	13/32 .4062-.4060	5/16	SP-26-5	
		3/8	SP-26-6	
		1/2	SP-26-8	
		3/4	SP-26-12	
		*1	SP-26-16	
.1562-.3160 5/32-O 4.00-8.00mm	1/2 .5000-.4998	5/16	SP-32-5	
		3/8	SP-32-6	
		1/2	SP-32-8	
		3/4	SP-32-12	
.3125-.4375 5/16-7/16 7.90-11.00mm	5/8 .6250-.6248	*1	SP-32-16	
		3/8	SP-40-6	
		1/2	SP-40-8	
		3/4	SP-40-12	
.3125-.5312 5/16-17/32 8.00-13.00mm	3/4 .7500-.7498	1	SP-40-16	
		3/8	SP-48-6	
		1/2	SP-48-8	
		3/4	SP-48-12	
.5000-.6562 1/2-21/32 13.00-16.50mm	7/8 .8750-.8748	1	SP-48-16	
		3/8	SP-56-6	
		1/2	SP-56-8	
		3/4	SP-56-12	
.5000-.7656 1/2-49/64 13.00-19.00mm	1 1.0000-.9998	1	SP-56-16	
		1/2	SP-64-8	
		3/4	SP-64-12	
		1-3/8	SP-64-22	

* Counterbored, leaving correct drill-bushing length and clearance (see page 514 for bearing length).

QUANTITY DISCOUNTS

Quantity	1	6	12	24	50	100	200	500
Discount %	Net	18%	29%	34%	42%	48%	50%	52%
Multiplier	1.00	.82	.71	.66	.58	.52	.50	.48

SPM SERRATED PRESS FIT METRIC



ID RANGE (G6)	OD (h5)	LENGTH	ANSI PART NO.	PRICE 1-5
1.00-1.80mm	5mm 5.000-4.995mm	6mm	SPM-5-6	
		9mm	SPM-5-9	
1.81-2.60mm		6mm	SPM-5-6	
		9mm	SPM-5-9	
2.61-3.30mm	6mm 6.000-5.995mm	8mm	SPM-6-8	
		12mm	SPM-6-12	
		16mm	SPM-6-16	
3.31-4.00mm	7mm 7.000-6.994mm	8mm	SPM-7-8	
		12mm	SPM-7-12	
		16mm	SPM-7-16	
4.01-5.00mm	8mm 8.000-7.994mm	8mm	SPM-8-8	
		12mm	SPM-8-12	
		16mm	SPM-8-16	
5.01-6.00mm	10mm 10.000-9.994mm	10mm	SPM-10-10	
		16mm	SPM-10-16	
		20mm	SPM-10-20	
6.01-8.00mm	12mm 12.000-11.992mm	10mm	SPM-12-10	
		16mm	SPM-12-16	
		20mm	SPM-12-20	
8.01-10.00mm	15mm 15.000-14.992mm	12mm	SPM-15-12	
		20mm	SPM-15-20	
		25mm	SPM-15-25	
10.01-12.00mm	18mm 18.000-17.992mm	12mm	SPM-18-12	
		20mm	SPM-18-20	
		25mm	SPM-18-25	
12.01-15.00mm	22mm 22.000-21.991mm	16mm	SPM-22-16	
		28mm	SPM-22-28	
		36mm	SPM-22-36	
15.01-18.00mm	26mm 26.000-25.991mm	16mm	SPM-26-16	
		28mm	SPM-26-28	
		36mm	SPM-26-36	

QUANTITY DISCOUNTS

Quantity	1	6	12	24	50	100	200	500
	-5	-11	-23	-49	-99	-199	-499	Up
Discount %	Net	18%	29%	34%	42%	48%	50%	52%
Multiplier	1.00	.82	.71	.66	.58	.52	.50	.48