



**ROEMHELD**  
HILMA ■ STARK

Issue 10-16 E

## M 2.201

### Tilting Module KME 100

Max. load 1,000 N, electrical operation



#### Advantages

- Easy tilting and fixing of components in angle positions 0° and 90°
- Holds self-locking in any intermediate position
- High load potential
- Good accessibility from all sides
- Easily combinable with other *modulog* modules
- Ergonomic working conditions
- Safe and quick working

#### Application

Tilting module for universal use in assembly and handling processes in the industry.

#### Principal use

- Assembly of car seats
- Motor assembly
- Plant construction
- Construction of power units

#### Fixing and installation

For fixing of *modulog* modules or other components of the user, the tilting module has an interface 140 x 140 at the base plate and the tilting clamping surface.

#### Mains cable 5 x 1.5 mm<sup>2</sup>

To be connected by the customer to the terminal strip in the control module (mains cable is not included in our delivery).

#### Operation

Tilting is made in touch control with hand panel or foot switch. After releasing the hand panel or foot switch, the tilting movement will be stopped immediately.

#### Description

The electric tilting module is equipped with a worm gear motor and offers the possibility to tilt components by up to 90° and to hold them in position in non-actuated mode. The desired position is approached by pressing a hand panel or foot switch in touch control. When the push-button is released, the tilting module stops in any desired position. The tilting module is automatically stopped by sensors in the positions 0° and 90°. With the electric tilting module, assembly processes can be realised quickly and efficiently. Ergonomic working conditions are fulfilled.

#### Available on request:

Tilting position 0, 30, 60 and 90 degrees.  
Tilting position 0, 30, 45, 60 and 90 degrees.  
Tilting position 0, 45 and 90 degrees.

#### *modulog*

#### Tilting module

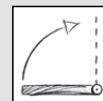

Part no. 6400-752

#### Technical data

Max. load: 1,000 N  
Max. torque: 230 Nm  
in relation to the rotating axis

#### Operation

- Foot switch
- Hand panel



#### Combinable with the modules

- Rotating module – vertical axis DMV 600 as per data sheet M 1.301



- Lifting modules as per data sheet M 4.XXX



#### *modulog* interfaces

- Flange plate: 140 x 140 - M10
- Body: 140 x 140 - Ø 10.5 mm

#### Accessories

- Electrical operating elements as per data sheet M 8.203

#### Control module 6862-717

included in our delivery

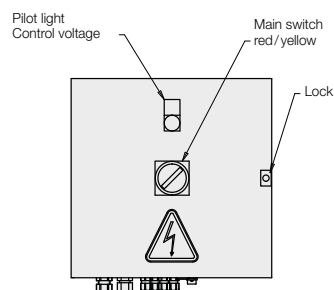

Tilting and control module are supplied with a 3 m long hard-wired cable.

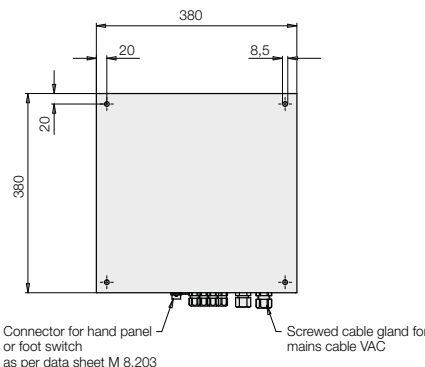
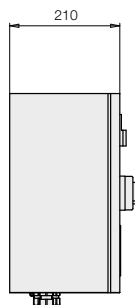

## Technical data Dimensions

### Dimensions

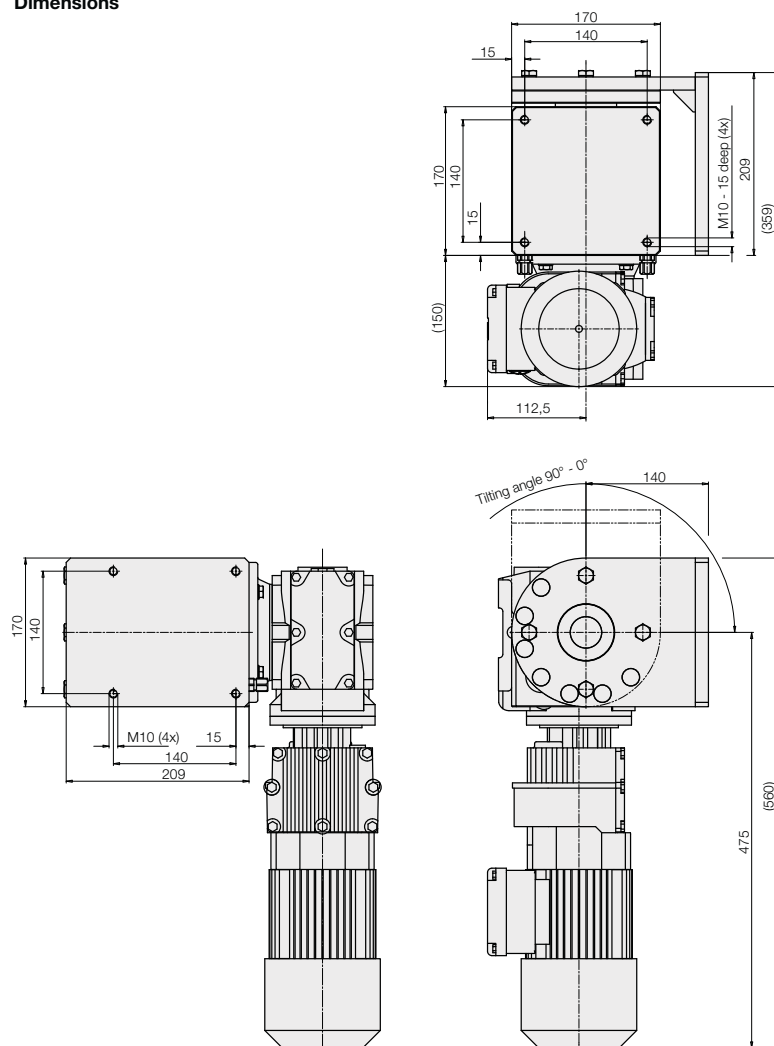

Part no. 6400-752

### Technical data

Operation	Switching contact or foot switch or hand panel
Tilting angle	0° to 90°
Supply voltage	230 V, 50 Hz
Code class	IP 54
Max. rotation speed	4.5 min <sup>-1</sup>

### Maximum admissible load

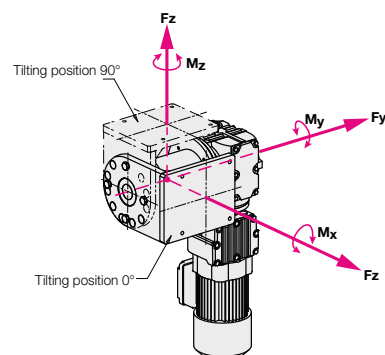

### Maximum admissible forces

**F<sub>x</sub>** = ± 1,000 N  
**F<sub>y</sub>** = ± 1,000 N  
**F<sub>z</sub>** = ± 1,000 N

### Maximum admissible torques

**M<sub>x</sub>** = 100 Nm  
**M<sub>y</sub>** = 230 Nm  
**M<sub>z</sub>** = 100 Nm

The total of all occurring forces or torques must not exceed the highest single value.

### Delivery

The electrical tilting modules are delivered with control module ready for connection. Electrical operating elements are available as accessories.

### Important notes!

The electrical tilting module is designed for applications within closed rooms.