

Swing clamps

SC-series

Collet-Lok® products

Swing clamps

Shown: SC-3, SC-1



SC series

These swing clamps rotate 90° as they begin their stroke, continuing without rotation for the final clamping stroke. Cylinders can be changed to left swing, right swing, or pull applications by loosening the side plug and then rotating the plunger to a desired position.

The SC-1 and SC-3 include a retract spring for single-acting operation. Both cylinders can be operated as double-acting cylinders by connecting a retract line to the vent port.

Changeable swing function

...with 360° fully adjustable clamp arm

- Changeable swing function: clamp arm movement can be adjusted to left or right swing, or straight pull function
- 88-92° clamp arm swing arc
- Easy installation: built-in mountings and brackets
- Compact design for use in limited space applications
- Easy and precise locating of arm for clamp positioning
- Single or double-acting cylinders to suit variety of hydraulic requirements.

Force: 2,2 - 9,6 kN

Stroke: 19,1 - 38,1 mm

Pressure: 138 - 207 bar

- Ⓔ Cilindros giratorios
- Ⓕ Vérins de bridage pivotants
- Ⓓ Schwenkspannzylinder

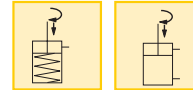

Arm length mm	Max. pressure bar	Clamping force kN
▼ SC-1		
-	207	11,7
51 ²⁾	207	9,6
76	207	8,7
102	207	7,7
127	166	5,3
152	138	3,7
▼ SC-3		
-	207	3,1
25 ²⁾	207	2,2
51	138	1,1

Selection chart

Clamping force ¹⁾	Stroke		Model number	Cylinder effective area		Oil capacity	
	mm	mm		cm ²	cm ³		
kN	Clamp	Total		Pull	Push	Pull	Push
9,6	12,7	38,1	SC-1	6,3	11,4	24,1	43,4
2,2	6,4	19,1	SC-3	1,6	2,9	3,0	5,4

¹⁾ With standard clamp arm (included with cylinder).

Note: - Long clamps arms can be fabricated by the user.

- For long clamp arms, use VFC series flow control valves.

²⁾ Standard clamp arm (included).

SC-1

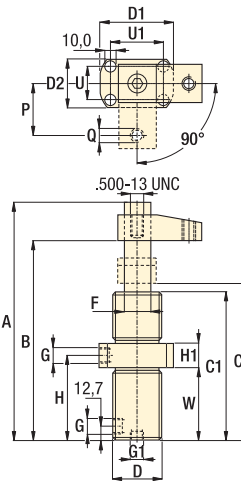

SC-3

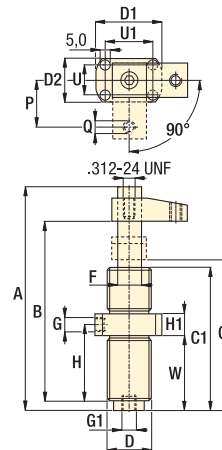

Product dimensions in mm [⌀]

Model number	A	B	C	C1	D	D1	D2	F	G	G1	H	H1	P	Q	U	U1	W	kg
								Ø	NPT	NPT				UNC				
SC-1	226	187	149	146	1.875-16UN	74	48	25	.250-18	.125-27	84,1	22,4	51	.375-16	32,5	52,3	73	2,7
SC-3	134	108	94	88	1.00-12UNF	51	29	13	.125-27	.125-27	54,6	16,0	25	.250-20	19,1	38,1	52	0,9