

Pressure reducing valves

PRV-series

Shown: PRV-3



PRV series

These valves regulate system pressure for all subsequent valves, according to the adjusted pressure. Maintains a constant pressure in a secondary circuit. Includes a check valve that prevents pressure drop on secondary side.

Application

Used when a hydraulic supply with a higher pressure (primary side) must also be used for another circuit with a lower pressure (secondary circuit).

The PRVM-2 manifold can be manifold mounted or plumbed with tubing. The PRV-8 and PRV-9 use this manifold to provide a pre-assembled valve. PRV-3 and 4 are for remote mounting. The cartridge from PRV-3 and 4 can be removed from manifold for direct integration into gundrilled fixture. Order the cartridge separately as PRV-3T or PRV-4T.

Precise control of hydraulic pressure

- Tool adjustable knob can be locked
- Precise control of pressure
- G1/4" oil connection
- Remote mount
- PRVM-2 manifold has both 1/4" BSPP and manifold ports
 - Gauge port- 1/8" NPT

Pressure: 350 bar

Flow: 7 l/min

- (E) Válv. reguladora de presión
- (F) Valve de pression réglable
- (D) Druckreduzierventil



Options

Gauges

□ 190 ▶



Fittings

□ 194 ▶



PRV-8, 9

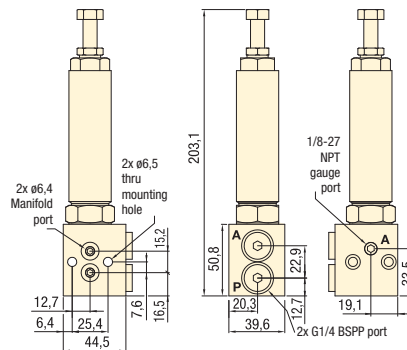

PRVM-2

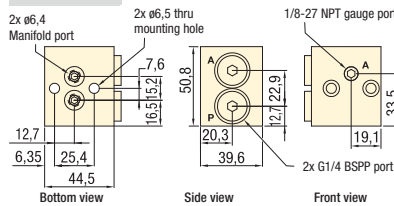

PRV-3, -4

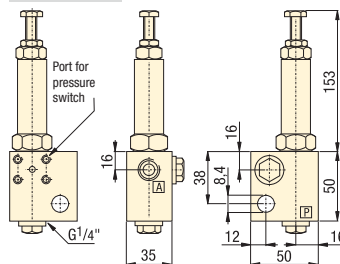

PRV-3T, -4T

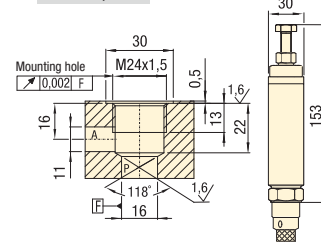

Product selection

Mounting style	Adjustable pressure range bar	Maximum pressure bar	Model number	Oil ports	Maximum oil flow	kg
				BSPP	l/min	
Remote	30 - 300	350	PRV-3	G1/4"	7	1,3
Cartridge	30 - 300	350	PRV-3T	-	7	0,7
Remote	5 - 130	350	PRV-4	G1/4"	7	1,3
Cartridge	5 - 130	350	PRV-4T	-	7	0,7
Remote	30 - 300	350	PRV-8	G1/4"	7	1,1
Remote	5 - 138	350	PRV-9	G1/4"	7	1,1
Remote	-	350	PRVM-2	G1/4"	7	0,6

Collet-Lok® products

Swing clamps

Work Supports

Linear Cylinders

Power Sources

Valves