



Description:

The flow rate transmitters in the series EVS 3100-H and EVS 3110-H with HSI sensor recognition have been specially developed for use in conjunction with HYDAC measuring instruments HMG 500, HMG 510, HMG 3000, HMG 3010 and CMU 1000.

For data transmission, the EVS 31x0-H has an HSI interface (HYDAC Sensor Interface).

The HSI sensors are recognised automatically via the HSI interface by the above-mentioned HYDAC measuring instruments, and all the necessary basic settings are taken from each instrument.

As with all flow rate transmitters in the series EVS 3100 and EVS 3110, the EVS 31x0-H also operates according to the turbine principle. The speed of an impeller turning in the fluid flow is measured and converted into an electronic signal.

Special features:

- Fully automatic recognition by, and voltage supply from, HYDAC measuring instruments HMG 500, HMG 510, HMG 3000, HMG 3010 or CMU 1000
- Automatic transfer of measuring range, measured value and measurement unit
- Viscosities of 1 .. 100 cSt
- Additional connection of temperature and / or pressure transmitters possible

Electronic Flow Rate Transmitter with HSI-Sensor Recognition

EVS 3100-H

EVS 3110-H

Technical data:

| Input data | | |
|---|--|-------------------|
| Measuring ranges ¹⁾ and operating pressure | | |
| EVS 3108-H-0020 | 1.2 .. 20.0 l/min | 400 bar |
| EVS 3118-H-0020 | | |
| EVS 3108-H-0060 | 6.0 .. 60.0 l/min | 400 bar |
| EVS 3118-H-0060 | | |
| EVS 3108-H-0300 | 15.0 .. 300.0 l/min | 400 bar |
| EVS 3118-H-0300 | | |
| EVS 3108-H-0600 | 40.0 .. 600.0 l/min | 315 bar |
| EVS 3118-H-0600 | 40.0 .. 600.0 l/min | 400 bar |
| Additional connection options | 2 x G1/4 female threads for pressure and/or temperature sensors | |
| Output data | | |
| Output signal | HSI (HYDAC Sensor Interface) Automatic sensor recognition | |
| Accuracy | ≤ 2 % of the actual value | |
| Environmental conditions | | |
| Compensated temperature range | -20 .. +70 °C | |
| Operating temperature range | -20 .. +70 °C | |
| Storage temperature range | -40 .. +100 °C | |
| Fluid temperature range | -20 .. +90 °C | |
| CE mark | EN 61000-6-1 / 2 / 3 / 4 | |
| Protection class to IEC 60529 | IP 67 (when an IP 67 connector is used) | |
| Other data | | |
| Housing material | EVS 3100-H: | Aluminium |
| | EVS 3110-H: | Stainless steel |
| Measuring medium ²⁾ | EVS 3100-H: | Hydraulic oils |
| | EVS 3110-H: | Water-based media |
| Viscosity range | 1 .. 100 cSt | |
| Calibration viscosity | EVS 3100-H: | 30 cSt |
| | EVS 3110-H: | 5 cSt |
| Voltage supply | via HYDAC measuring instruments HMG 500, HMG 510, HMG 3000, HMG 3010 or CMU 1000 | |

Note: ¹⁾ Other measuring ranges on request

²⁾ Other fluids on request

Model code:**EVS 3 1 X 8 – H – XXXX – 000****Housing material**

- 0 = Aluminium
1 = Stainless steel

Electrical connection

- 8 = Male M12x1, 5 pole
(connector not supplied)

Signal

- H = HSI (Automatic Sensor Recognition)

Measuring range

- 0020 = 1.2 .. 20 l/min
0060 = 6.0 .. 60 l/min
0300 = 15.0 .. 300 l/min
0600 = 40.0 .. 600 l/min

Modification number

- 000 = Standard

Note:

On instruments with a different modification number, please read the label or the technical amendment details supplied with the instrument.

Accessories:

Appropriate accessories, such as electrical connectors, can be found in the Accessories brochure.

Note:

The information in this brochure relates to the operating conditions and applications described.

For applications or operating conditions not described, please contact the relevant technical department.

Subject to technical modifications.

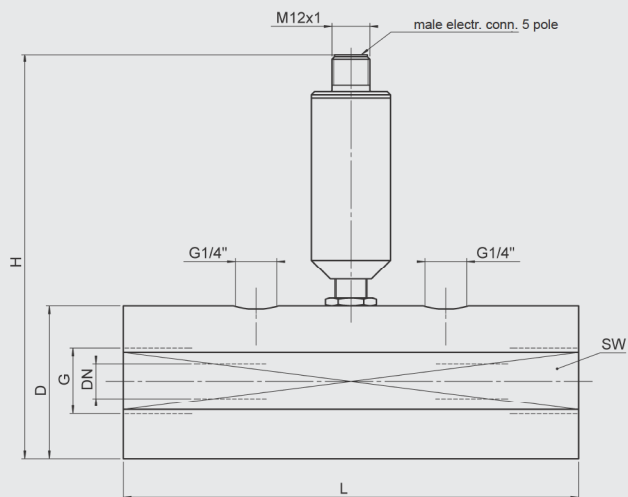
Dimensions:

| Model | Meas. range [l/min] | L [mm] | H [mm] | D / SW [mm] | G [mm] | Torque value [Nm] | DN [mm] |
|-----------------|------------------------|-----------|-----------|----------------|-----------|----------------------|------------|
| EVS 3108-H-0020 | 1.2 .. 20 | 117 | 135 | 47 / 46 | G1/4" | 60 | 7 |
| EVS 3108-H-0060 | 6 .. 60 | 144 | 135 | 48.5 / 46 | G1/2" | 130 | 11 |
| EVS 3108-H-0300 | 15 .. 300 | 155 | 150 | 63.5 / 60 | G1 1/4" | 500 | 22 |
| EVS 3108-H-0600 | 40 .. 600 | 181 | 150 | 63.5 / 60 | G1 1/2" | 600 | 30 |
| EVS 3118-H-0020 | 1.2 .. 20 | 117 | 135 | 47 / 46 | G1/4" | 60 | 7 |
| EVS 3118-H-0060 | 6 .. 60 | 144 | 135 | 48.5 / 46 | G1/2" | 130 | 11 |
| EVS 3118-H-0300 | 15 .. 300 | 155 | 150 | 63.5 / 60 | G1 1/4" | 500 | 22 |
| EVS 3118-H-0600 | 40 .. 600 | 181 | 150 | 63.5 / 60 | G1 1/2" | 600 | 30 |

